



Anthra Subwoofer Series

Product Manual

Register your Anthra Subwoofer
to ensure the best possible product and customer support

Register your speakers using the QR code
or visit [monitoraudio.com/registration](https://www.monitoraudio.com/registration)



Welcome to Anthra

Thank you for purchasing one of our Anthra Subwoofers, you're now ready to start your journey to breathtaking sound.

It takes confidence to dare to be simple. Anthra subwoofers embrace this methodology. Our standalone subwoofer series partners innovative acoustic know-how with an intuitive user-experience. Which isn't as simple as it sounds.

In this product manual, you'll find information about setting up your subwoofer and how to maintain your subwoofer for a lifetime of enjoyment.

If you need any further assistance, please contact our technical team at [monitoraudio.com/support](https://www.monitoraudio.com/support)

Contents

Spikes & feet	2
Controls & connections	4
Front LED colour matrix	6
Setting up	8
On-screen menu	10
MaestroUnite app	12
Factory reset	14
Care & maintenance	15
Warranty	16
Specifications	17

Use on wooden or hard floors

The foot comes fully assembled for use on hard floors. All that is required is fixing into the bottom of the cabinet. This is achieved by simply screwing the feet fully into the 4-threaded inserts in the underside of the cabinet.

Use on carpeted floors

For carpeted floors, or where spikes are appropriate, the spike can be screwed into the foot assembly. If your carpet has a very thick pile, remove the soft polymer pad from the foot to ensure the spike goes all-the-way through the carpet into the floor.

 Please ensure there are no hidden wires under the carpet that could be damaged by the spikes.

Levelling the speaker

Place the cabinet in your desired location, and check that it is level on all sides. If it is slightly uneven, unscrew the main threaded assembly at the lowest point and check again.

Continue this process until the cabinet is fully level. Use the locking nut on the foot to fix the foot in place and to stop any unwanted vibrations.

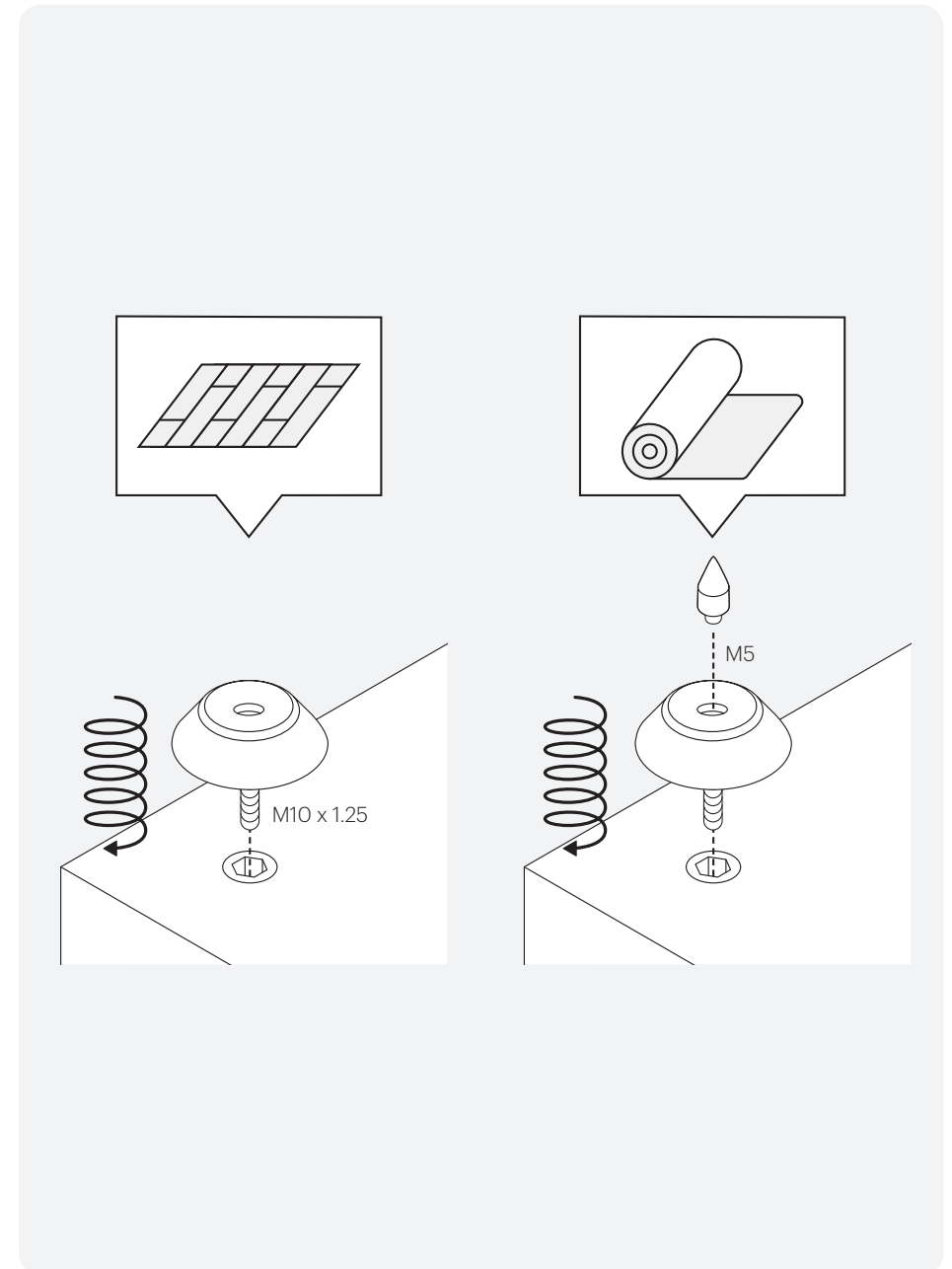

1 - Encoder

Press the Encoder to wake up the Subwoofer and to select options within the Subwoofers menu system. Turn the encoder to scroll the menu and to change the volume, Low Pass Filter settings, and EQ presets in the menu.

2 - Screen

Displays the Anthra menu for setup using the encoder. Refer to page 10 for more on the menu system layout.

3 - Factory Reset

With the subwoofer switched On, press and hold for 5 seconds to perform a factory reset of the Anthra subwoofer. To access the button use a thin or pointed object.

4 - RCA Line Level Inputs

For connection to a 2 channel/ stereo amplifier system, connection should be provided by a pair of high-quality signal cables from the pre-out section of an amplifier. Connection from an AV receiver or processor should be made using a single subwoofer cable into either of the inputs.

NOTE: Cable lengths should not exceed 10 metres to avoid interference from other electrical appliances.

5 - RCA Line Level Outputs

To be used to feed additional sub-woofers or power amplifiers from the Anthra subwoofer by 'daisy chain' type connection. The outputs are link-out only connections and do not provide any form of filtering or amplification. There must be a signal into the RCA inputs for the linked outputs to work.

NOTE: Cable lengths should not exceed 10 metres to avoid interference from other electrical appliances.

6 - 12 Volt Trigger Input ~ Centre Pin Tip = +12Vdc

For external power control from an AV amplifier/ receiver to the Anthra Subwoofer. Monitor Audio recommend using this function and a lead is supplied. This 12 volt signal is generated by the AV amp/receiver and tells the Subwoofer to turn On from standby mode. This allows a more accurately controlled auto On/Off function, and is far more energy efficient.

7 - Balanced LFE Input (Female XLR Type)

To be used when connecting to the balanced output on the amplifier. This is the best method of connection when using long runs of cables (over 10m up to 100m). A balanced connection provides a much better, almost noise free method of connection over RCA connectors.

8 - Balanced LFE Output (Male XLR Type)

To be used to feed additional sub-woofers or power amplifiers from the Anthra subwoofer by 'daisy chain' type connection. This is the best method of connection when using long runs of cables (over 10m, up to 100m). A balanced connection provides a much better (almost noise free) method of connection over RCA connectors. The output is a link-out only connection and does not provide any form of filtering or amplification. There must be a signal into the XLR input for the linked output to work.

9 - IEC Mains Input Socket

The subwoofer is supplied with a three-pin mains input socket for connection to the mains supply. Use ONLY the appropriate IEC mains lead provided with the product.

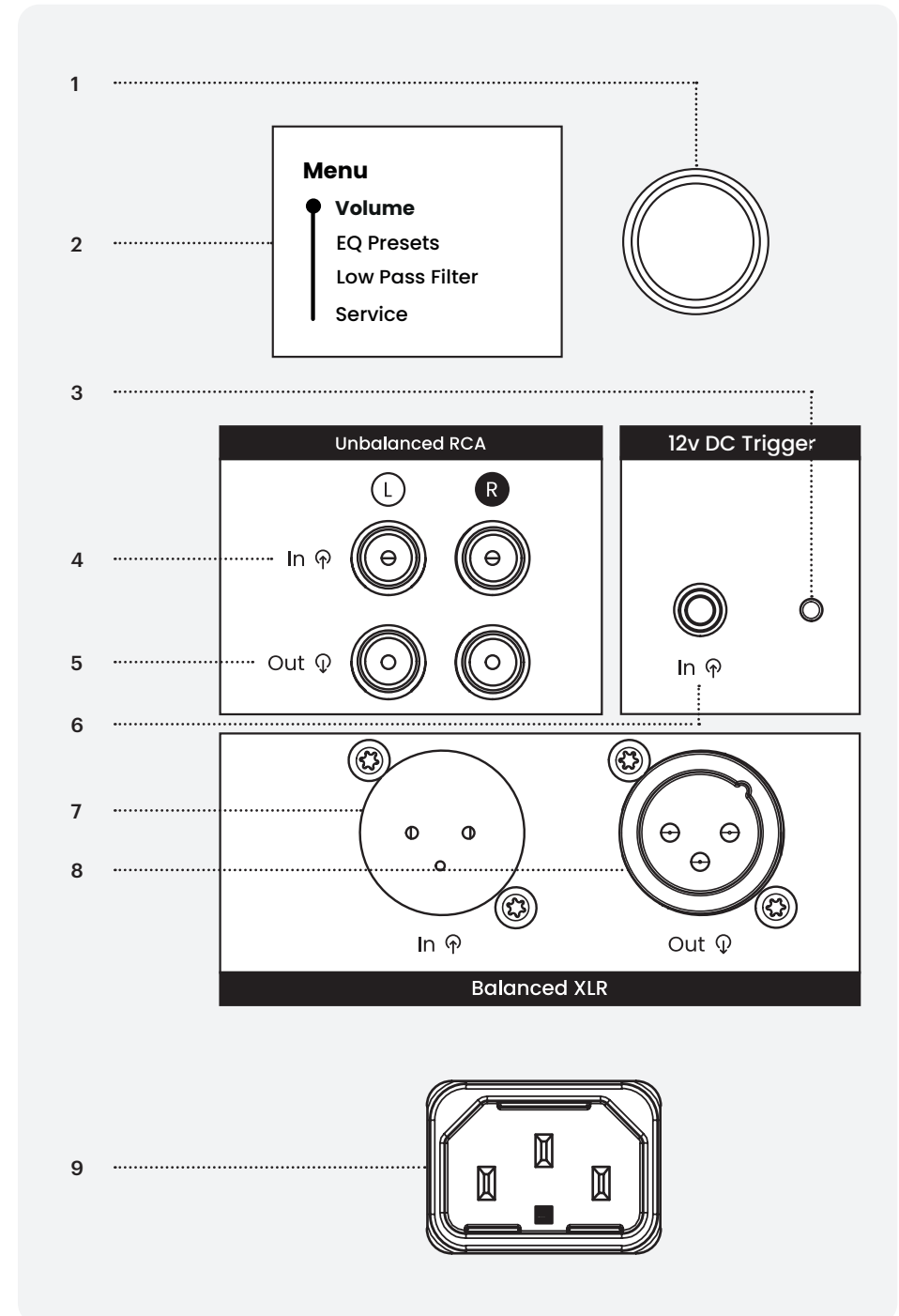

Front LED colour matrix

The front LED has multiple colours/ indicators.
Please refer to the below table for their meaning.

Function		Indication
Unit Standby		Continuous Red
Power On	Power Up Sequence	3 x Red Pulses
	Unit On	Continuous Orange
BLE Pairing	Pairing Complete	Quick Flashes Orange for 3 seconds
Paired State	Check connection option selected in MaestroUnit App	Quick Flashes Orange for 3 seconds
OTA Update Mode	Updating Process	Continuous Blue
Fault Indications	General	White
	Temperature	Flashing Orange & White
	DC or Overcurrent Error	Flashing Orange & Yellow
Factory Reset	Reset	Continuous Green
	Completed	Continuous Red (Standby)
Mute On		Continuous Flashing Orange
LED	Brightness Level Adjustment	Dimming Level Indication
	Off	All LED Indications Off

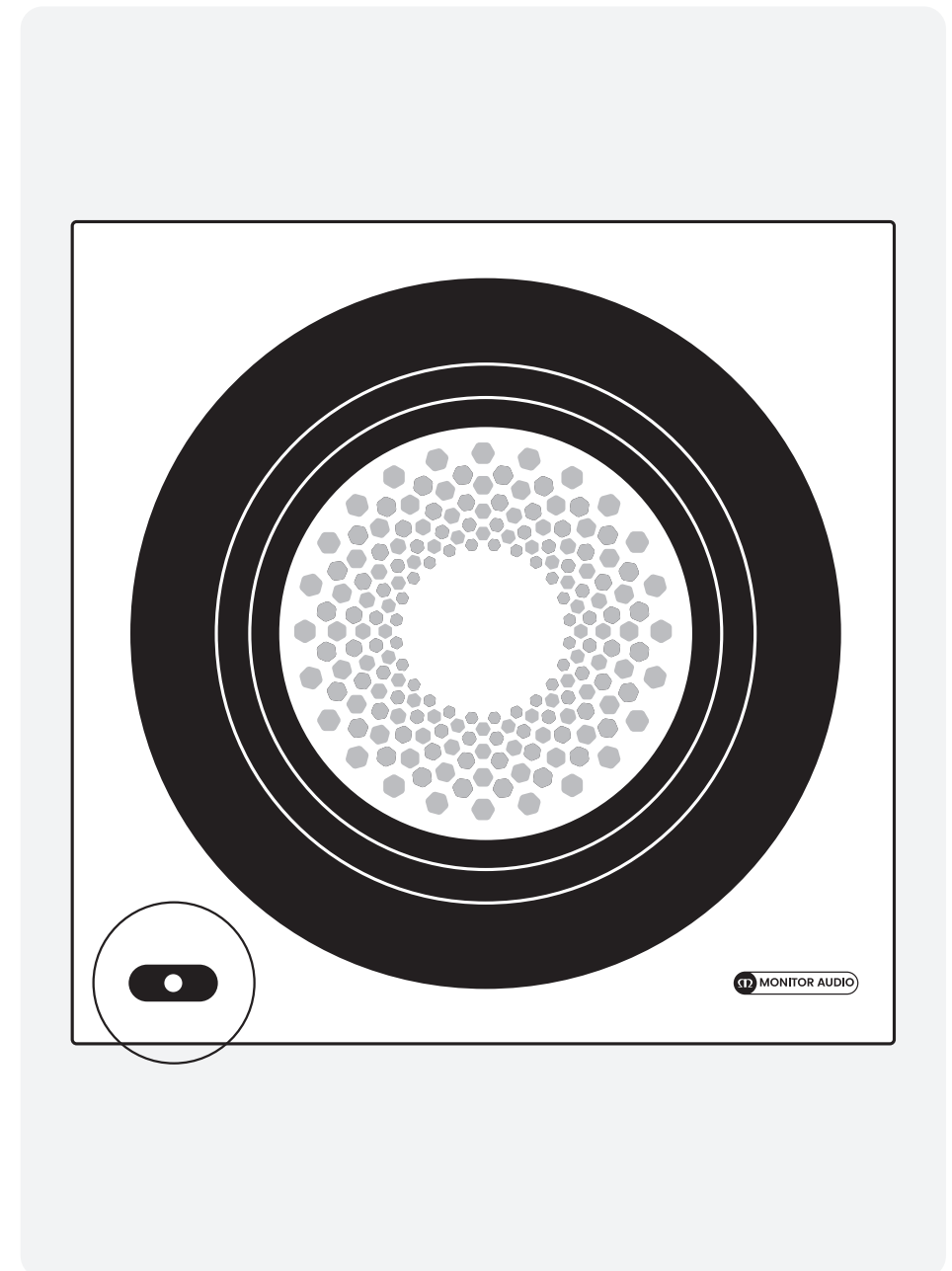

Initial set-up

Follow the steps to get started setting up your Anthra Subwoofer. More detail for each step is also given in the corresponding sections.

Leave the subwoofer unplugged from the mains until all signal cables are connected.

1. Position subwoofer, all features and settings can be configured using the MaestroUnite app or from the back of the subwoofer.
2. Connect the signal cables based on your system, refer to the AV or Stereo System section below.
3. Connect the IEC mains lead provided and switch the subwoofer On by pressing the encoder.
4. Download MaestroUnite, refer to page 12.
5. Connect to MaestroUnite.

Positioning

The subwoofer should be sited in the most suitable position, preferably not directly in the corner of a room as this may cause excessive bass boom. Once a desirable position is achieved it is important to check if the cables are long enough to reach comfortably without being under tension. If using the RCA inputs, cables should be less than 10 metres to avoid interference.

Audio Connections

When using a mono subwoofer output from your amplifier/ receiver, connection is made by RCA type connectors to the left or right input or a balanced XLR connection.

If a stereo RCA connection is preferred, connect to the left and right RCA inputs from the pre-amp outputs on your source amplifier.

When daisy chaining to an additional product ensure the output from the Anthra Subwoofer is connected to the corresponding input on the Anthra Subwoofer. For example, use the left RCA input and left RCA output. Not the Left RCA input and balanced XLR output.



Do not connect or disconnect the signal leads with the Anthra Subwoofer switched on.

Power

To power on the subwoofer connect the supplied IEC power cable and press the encoder on the amp panel. The Monitor Audio Logo will briefly appear on the screen followed by the menu system. The Anthra subwoofer can also be set to wake from standby using Music Sense or the 12v Trigger from the MaestroUnite app.

AV System

By default the Anthra LPF is bypassed, we recommend setting the crossover at the receiver or amplifier. This is usually done as part of the automatic setup on the AV amplifier/ receiver. It is recommended to double check the settings of the automatic setup to ensure the levels and crossover settings are correct.

Stereo System

It is recommended to use an AV amplifier/ receiver or an amplifier with dedicated sub out to simplify setup and achieve the best performance. However if this is not possible, when connecting using this method, you use the LPF settings in the Anthra Subwoofer to allow only the bass frequencies to be played. This can be done using the encoder or the MaestroUnite app.

For best practice when integrating the Anthra Subwoofers with Monitor Audio loudspeakers, we would recommend using the port bungs - where supplied with the speakers (replacements or additional bungs can be purchased from Monitor Audio or their partners), and setting the LPF -3dB frequency to that of the tuning frequency of the port where this data is available from our website. If this isn't quoted, use the table below as a guide and experiment with the frequency to find the perfect setting for you and your listening environment. The slope angle for the LPF should be kept at the default -12dB/ octave.

For use with other manufacturers speakers, please refer to the table below as a guide and experiment with the frequency to find the best setting for your tastes and listening environment, although a good starting point is to set the LPF -6dB frequency on the subwoofer to the -6dB in room frequency if that is quoted on the manufacturers website. For use with ported loudspeakers, and no port bungs, use a -24dB/ Octave slope and for sealed cabinets or those with blocked ports, use a -12dB/ octave slope.

Type of Main Speaker	Crossover Control Setting
Large floor-standing speaker	20-80 Hz
Small floor-standing speaker	30-80Hz
Large stand-mount/ bookshelf speaker	30-80 Hz
Small stand-mount/ bookshelf speaker	40-100 Hz
Small satellite speaker	80-120 Hz

To improve the integration further, including optimising the phase alignment, please see the Monitor Audio Guide to Tuning Subwoofers.

On-screen menu

Using the encoder and screen on the Anthra amplifier panel you can adjust the volume, low pass filter and select EQ presets. You can also check for firmware updates if the subwoofer is connected to the network.

See the opposite page for the menu structure.

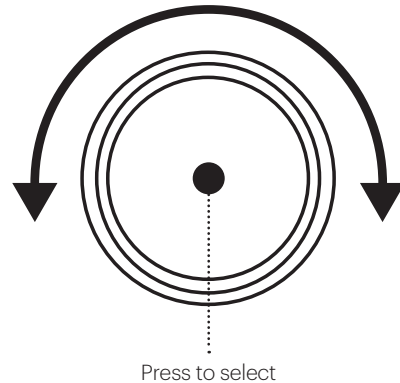
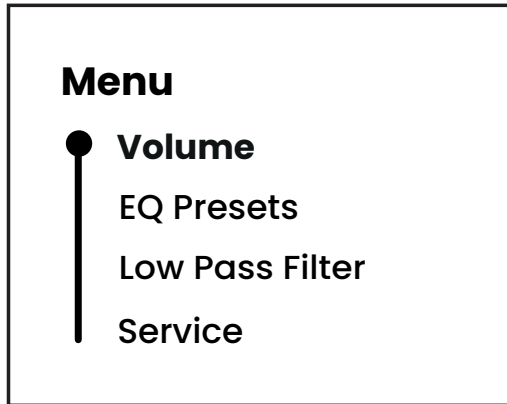

Volume

A stepped volume control ranging from -40 - 20 dB.

EQ Presets

Here you can select from a list of three predefined Monitor Audio presets (Music, Movie, Impact) designed by our audio experts, or three custom presets. These can be created and saved to the subwoofer using the MaestroUnite app.

Low Pass Filter

By default the Low Pass Filter is disabled, for use with a filtered signal from an AV receiver or amplifier. If your connection is from a full range source, for example a stereo amplifier, you should enable the Low Pass Filter to allow only the bass frequencies to be played. Adjustable between 40-200 Hz.

Service

If your Anthra subwoofer is connected to a network (see MaestroUnite on page 12) you can check here for firmware updates. You can also put the subwoofer into standby manually.

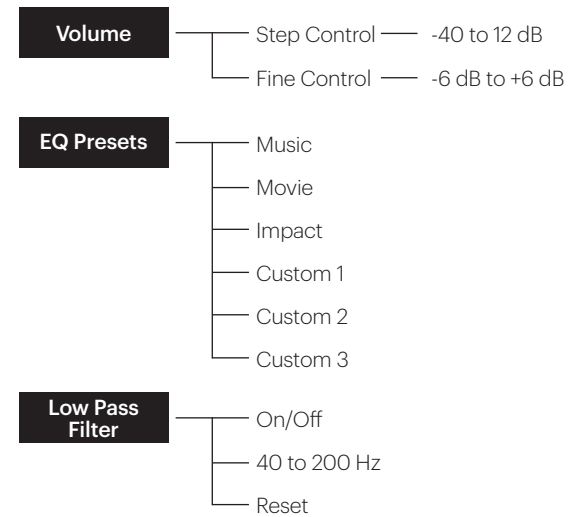

Download the MaestroUnite app from the Google Play Store (Android) or Apple Store (iOS). In the MaestroUnite app you can control / select all functions available in the on-screen menu described previously and additional settings such as Auto-On, Phase, Custom EQ, LED Brightness and more.

Creating a System & Connecting to a Network

To create a system, open the MaestroUnite app and press the '+' icon in the top right to set up a new system as highlighted in the image below.

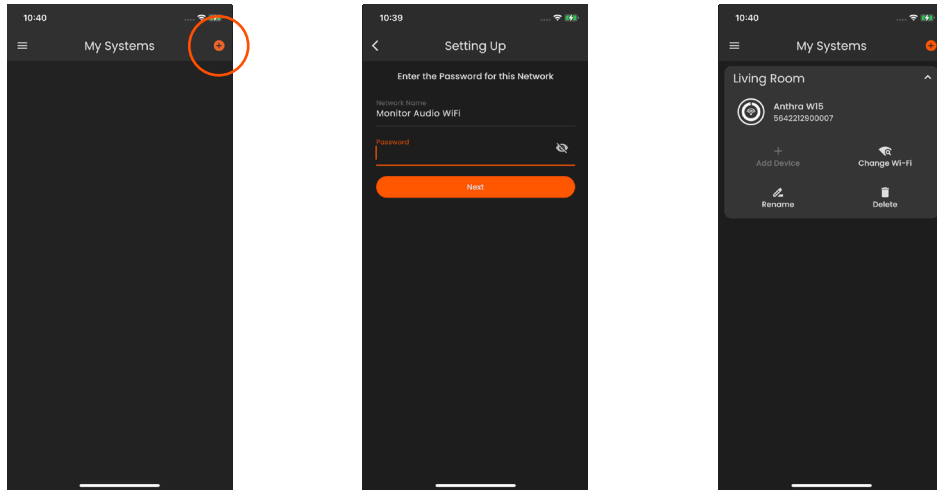

You will first be asked to choose a name for the system, then follow the on screen prompts to connect to your Anthra Subwoofer and enter the Wi-Fi credentials for your network.

Anthra Subwoofers are listed with their serial number for ease of identification when using multiple subwoofers. Once connected your Anthra Subwoofer will be displayed as a system on the home page of MaestroUnite.

Creating a Custom EQ Preset

One of the many customisable features of Anthra is that you can create your own Custom EQ Presets. To do this open MaestroUnite and tap on the Anthra Subwoofer system you have created, this will open the "Device Information". Scroll down to "Sound" and tap on the "EQ Presets" option.

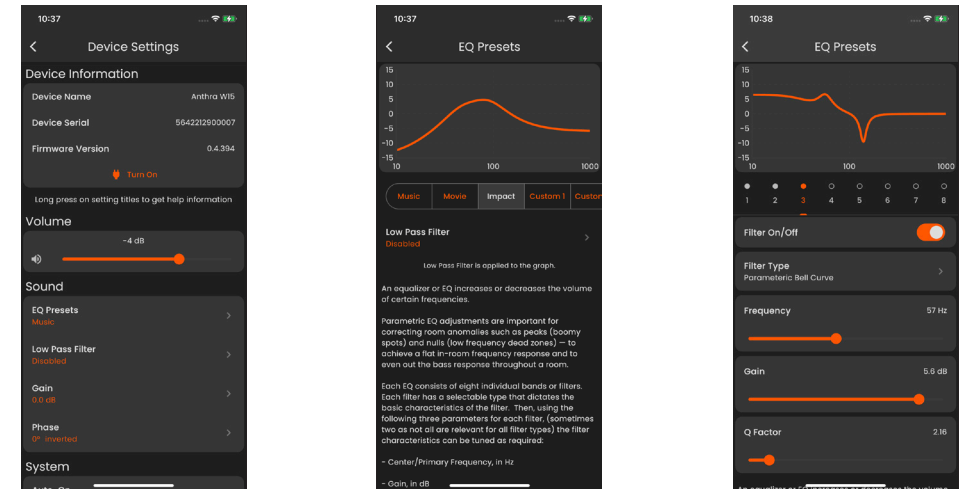

To create your own Custom EQ Preset select the Preset you wish to edit (Custom 1, 2, 3).

Note: If a Low Pass Filter has been previously set, this will be applied to all presets including custom presets.

Below the EQ graph is an 8-band Parametric EQ, of which each filter can be individually selected and switched On/ Off. When enabled you can set the Filter Type, Frequency, Gain and Q Factor. Definitions for each setting are given within MaestroUnite.

Settings will be saved and applied to the subwoofer automatically. Tap "Reset This Filter" to clear any changes made.

Factory reset

Should the need arise to carry out a factory reset on your Anthra Subwoofer simply hold down the Factory Reset button on the back of the amplifier panel for approximately 5 seconds whilst the subwoofer is switched On. The amplifier panel screen will display "Factory Reset in Progress" before entering standby mode.



NOTE: all Wi-Fi details will be erased as well as any other settings and customisation.

Care & maintenance

Upkeep of cabinets

The finish of the cabinet can be maintained by regular dusting using a soft or micro fibre cloth. The drive units should only be cleaned with a damp cloth, if more than normal dusting is required.

Be careful not to damage the driver units whilst cleaning.

Never use solvents or aggressive cleaning/polishing agents on your Anthra Subwoofer. When in doubt, test the cleaning product on an inconspicuous area on the cabinet, and let it sit for several days before committing to its use on visible portions of the cabinet.

Warranty

In the unlikely event that there is a defect with this product, it is covered by the Monitor Audio manufacturer's warranty, provided that the product was supplied by an authorised Monitor Audio retail specialist.

For the period of cover please refer to the product page on our website at monitoraudio.com

Register your Anthra Subwoofer
to ensure the best possible product and customer support

Register your speakers using the QR code
or visit monitoraudio.com/registration



Specifications

	Anthra 10	Anthra 12	Anthra 15
System Format	Active - Sealed Cabinet		
Drive unit Complement	1 x 10" (254 mm) High Linear-Excursion Triple Suspension Driver	1 x 12" (305 mm) High Linear-Excursion Triple Suspension Driver	1 x 15" (381 mm) High Linear-Excursion Triple Suspension Driver
Amplifier Classification	High-Efficiency Class-D		
Lower Frequency Limit	-6 dB @ 17 Hz	-6 dB @ 16 Hz	-6 dB @ 16 Hz
Upper Frequency Limit	(LPF Off) -6 dB @ 400 Hz		
Driver Excursion (pk-pk)	50 mm (1 15/16")		
DSP	28 Bit 50 MIPS Configurable through MaestroUnite app		
Analogue Digital Conversion	Auto ranging Input which combines a 10 Vrms maximum input with low signal to noise for small signals		
Amplifier Output Power, 240 VAC	Instantaneous: 500 W* Continuous short-term: 425 W**	Instantaneous: 1700 W* Continuous short-term: 900 W**	Instantaneous: 2500 W* Continuous short-term: 1400 W**
Amplifier Output Power, 120 VAC	Instantaneous: 450 W Continuous short-term: 390 W	Instantaneous: 1325 W Continuous short-term: 700 W	Instantaneous: 2500 W Continuous short-term: 1400 W
LED UI Control	Brightness, On-Off		
Phase Control	0-360 Degrees measured at LPF Crossover		
Low Pass Filter	20-200 Hz LPF with Rolloff Adjustable from -3 to -48 dB/Oct		
Custom EQ	Configurable through MaestroUnite; 3 pre-defined EQ curves plus 3 custom EQ curves each with 8 band custom EQ supporting Peaking, High Shelf, Low Shelf and High Pass.		
Volume Level	Wide adjustable input gain to allow maximum output from a wide range of input signals		
Inputs	Stereo Unbalanced RCA Mono/LFE Balanced XLR		
Outputs	Stereo unbalanced outputs with unbuffered throughput from RCA Inputs Mono/LFE Balanced XLR outputs with unbuffered throughput from XLR Input		
Mains Input Voltage	Universal Mains, 85-265 VAC		
External Dimensions Without feet (H x W x D)	321 x 321 x 321 mm (12 5/8 x 12 5/8 x 12 5/8")	374 x 374 x 374 mm (14 3/4 x 14 3/4 x 14 3/4")	439 x 439 x 439 mm (17 5/16 x 17 5/16 x 17 5/16")
Weight	22.2 kg (48 lb 15 oz)	32.4 kg (71 lb 7 oz)	40.3 kg (88 lb 14 oz)
Power consumption	120 W	200 W	550 W
Cabinet Construction	Braced 18 mm thick MDF with 36 mm front baffle	Braced 25 mm thick MDF with 36 mm front baffle	
Grille	Cloth covered magnetically attached grilles		

* Maximum RMS output for an instantaneous signal ** Sinewave for 10 seconds

Listen Again.

Monitor Audio Ltd.
24 Brook Road
Rayleigh, Essex
SS6 7XJ
England
Tel: +44 (0)1268 740580
Email: info@monitoraudio.group

[monitoraudio.com](https://www.monitoraudio.com)